

Welcome to the

10th ANNUAL POSTCARD EXPO

Sponsored by the Lancaster County Postcard Club
Lancaster, Pennsylvania

Saturday, 9 to 5

August 17, 2002

Farm & Home Center

Manheim Pike, Rte. 72

Near Rte. 30 By-pass

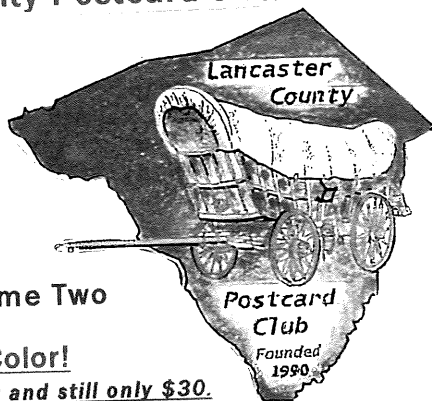

"Windows to Our Past" - Volume Two
makes its debut TODAY.

520 Local Views - 109 in Color!

20 more views than Vol. One, 50 more in color and still only \$30.

"Give me a sentence with that word in it."
"The seat of my trousers is worn out but
notwithstanding."



"WHAT DID THEY TEACH YOU ON YOUR
FIRST DAY AT SCHOOL, JIMMY?"
"NOT MUCH MUM—I'VE TO GO
AGAIN TOMORROW!"



A 'BAMFORTH' COMIC

2002 LCPC Officers

Pres. Tom Beck

Vice. Pres. Bryan Benner

Secy. Mary Ann Guntow

Treas. Barabara Mowrer

This year's Expo Program cover is dedicated
to Pres. Tom Beck, retired pedagogue with
an overactive humorous vein.

LCPC Directors

Harold Moyer 2001-2002

Ruth Moyer 2001-2002

Jim Ward 2001-2002

Dede Schaeffer 2002-2003

Doug Milliken 2002-2003

Bill Guntow 2002-2003

LCPC Member – Dealers

Alphabetical Listing

- 17 BIESECKER, Dale and Gretchen
- 20 BISHOP, Dick
- 23 CAVALARI, Agnes
- 4 COX, Shirley
- 5 GOTTLIEB, Marilyn and Howie
- 2 GRAY, Harris and Jayne
- 9 GREIDER, Jere
- 10 HARTMAN, Reuel
- 3 MCKINZIE, Gordon
- 14 MIDDLETON, Mike
- 7 MILLER, Jay
- 13 MORRISON, Jim
- 24 NEIS, Steve
- 18 NEWSOME, Arden and Bob
- 1 RODRIGUEZ, Jose and Aida
- 6 ROWE, Dolores and Leon
- 22 RUSSELL, Chris and Pam
- 16 SCHAEFFER, Dede
- 15 SCHURZ, Maria and Win
- 9 STEINBERG, Howard
- 11 STOVER, Leighton
- 21 TROVEI, Barbara
- 12 WACHTER, Don
- 8 WARD, Jim
- 19 WOLFERSBERGER, Bill

Numerical Listing

- 1 Jose Rodriguez
- 2 Harris Gray
- 3 Gordon McKinzie
- 4 Shirley Cox
- 5 Marilyn Gottlieb
- 6 Dolores Rowe
- 7 Jay Miller
- 8 Jim Ward
- 9 Jere Greider
- 9 Howard Steinberg
- 10 Reuel Hartman
- 11 Leighton Stover
- 12 Don Wachter
- 13 Jim Morrison
- 14 Mike Middleton
- 15 Maria Schurz
- 16 Dede Schaeffer
- 17 Dale Biesecker
- 18 Arden Newsome
- 19 Bill Wolfersberger
- 20 Dick Bishop
- 21 Barbara Trovei
- 22 Chris Russell
- 23 Agnes Cavalari
- 24 Steve Neis

Where You'll Find Them

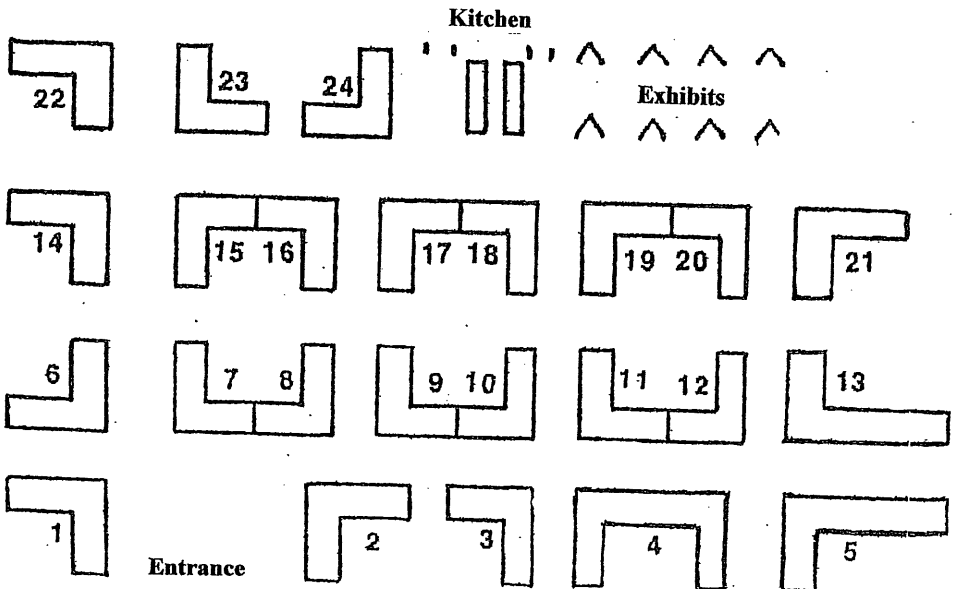

You're invited to become a member of LCPC – the Lancaster County Postcard Club.

An application can be found on the back of this program.

Our meetings are held the third Monday of each month from 5:30 to 9 p.m. here at the Farm & Home Center. They are open to the public. You may join us in sharing what we learn about postcards through our entertaining and educational programs and our club library. We have competitive postcard exhibits at nearly every meeting.

Dues – Special Expo Offer

LCPC's fiscal year is April to March for which we charge \$8. Sign up at the Expo for a special rate of \$12. It pays your dues from Aug. 2002 through March 2004.

Our monthly Publication, *The Card*, includes club news, local postcard history and articles covering postcard collecting in general. Ask for a complimentary copy

Highlights of the year include publishing a National Postcard Week card in spring, a picnic and our Annual Expo in summer, a postcard auction in the fall and our annual Christmas party.

The only Postcard Club published books of their kind.

In 1998 our club published a hard cover deluxe edition book of 500 local postcard views with descriptions and values. *Windows to Our Past*, we've learned, is the first book of its size and substance to be published by a postcard club. The edition of 2,000 copies was sold out in five months. Copies are now selling at a premium.

This year LCPC took up the venture once more. *Windows to Our Past, Volume Two*, makes its debut at our 2002 Expo. It includes 520 different views from *Volume One* and we've increased the color plates from 49 to 109 while holding the price at \$30! As quickly as *Volume One* sold out, you might consider getting your extra copies today. Relatives and friends who've moved from Lancaster will certainly enjoy the nostalgia conjured up by these old postcard views. They'll make wonderful Christmas gifts.

Voting is a privilege.

**Cast your exhibit ballot for
the People's Choice Award**

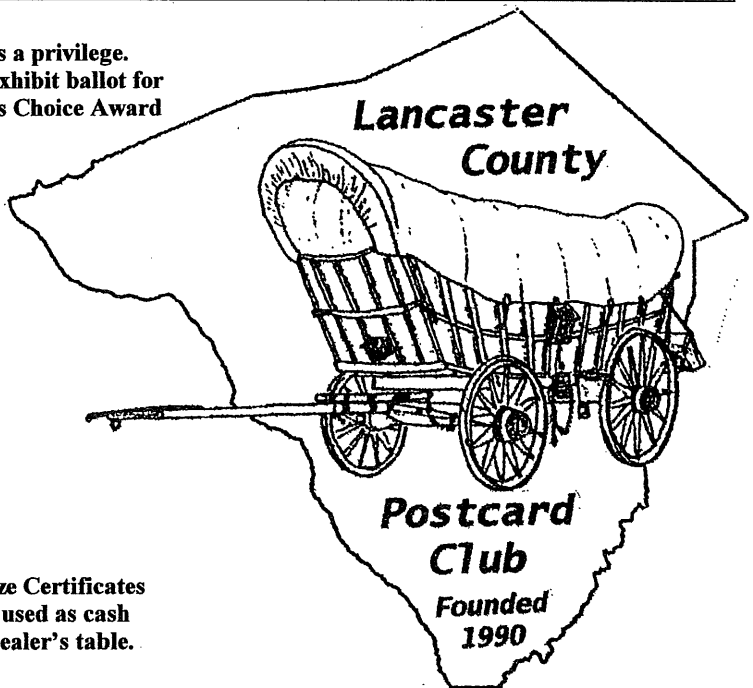

**Door Prize Certificates
may be used as cash
at any dealer's table.**

Which are the most troublesome, Tommy, worms
or sparrows?
Don't know teacher; I've never had sparrows!



"WHY DON'T YOU WANT TO GO TO HEAVEN, JACOB?"
"COS I WANT TO GO TO THE OTHER PLACE, WHERE
FATHER SAYS OUR BUSINESS IS GOING!"

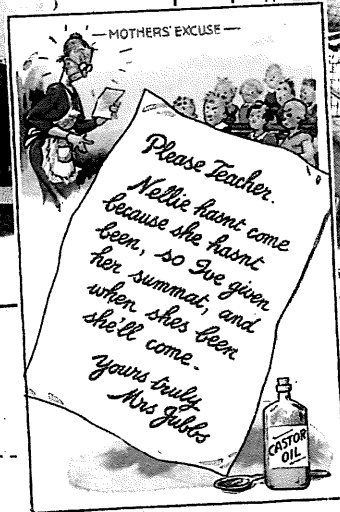
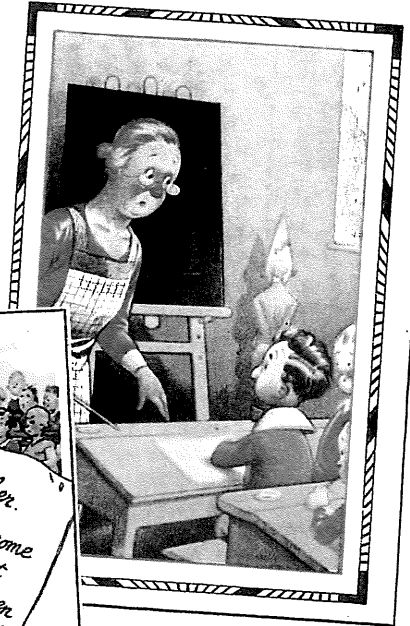

Comic postcards by
Bamforth & Co., Ltd.
except "Notwithstanding"
by Inter-Art.

DATE

Post Card

LANCASTER COUNTY POSTCARD CLUB

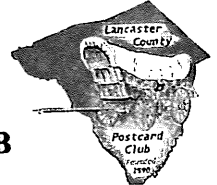

MY POSTCARD COLLECTING
INTERESTS ARE

APPLICATION FOR MEMBERSHIP

.....
.....
.....
.....

NAME

ADDRESS

TOWN

STATE ZIP

AMT. PAID.....DATE.....

PHONE

ACCEPTED BY

SPONSOR

Published by "L & W" Lancaster, PA